



## ProPanel - Light BackerBoard

**IT'S AS EZ AS 1... 2... 3!**



**Cut the ProPanel\***



**Fasten with approved fasteners every 8"**



**Treat all joints, penetrations and fasteners with approved polyurethane caulking. Allow caulk to ooze between joints and spread to form a thorough seal.**

**Buy Now**

ProPanel™ Foam Based Backer Board is light in weight and heavy in duty!

Complies with industry specified guidelines

Waterproof — never rots or degrades

Excellent for cut-to-fit site applications

Never rots or degrades

**Time saving... Waterproof... Worry Free. The difference is CLEAR.**

ProPanel™ is a lightweight and waterproof insulated backer board specifically designed for wall tile applications. Made of high density expanded polystyrene reinforced, on both sides, with a fiberglass mesh and cement mortar coating, ProPanel™ is a superior backer board for ceramic tile used on walls, bathtub surrounds, and countertops\*.

Despite every precaution in today's building market, moisture and mold are frequent problems.

The key to preventing mold and fungi problems is moisture control. **ProPanel™** has passed the demanding **ANSI A118.10 – Section 4.5 – Waterproof** testing in accordance with the Hydrostatic Pressure Test in ASTM D-4068, Annex A2.

ProPanel™ has also passed **ASTM G-21 and G-22 – Resistance to Fungi and Bacteria.**

**ProPanel™ delivers superior performance in resisting moisture and mold.**

The 2-pound density foam core in ProPanel™ Backer is stable and will not rot or deteriorate in use. ProPanel™ Backer is specifically designed for use in high moisture areas such as showers, tub surrounds and steam room installations.

Because of its low vapor permeance, ProPanel™ Backer eliminates the need for additional moisture

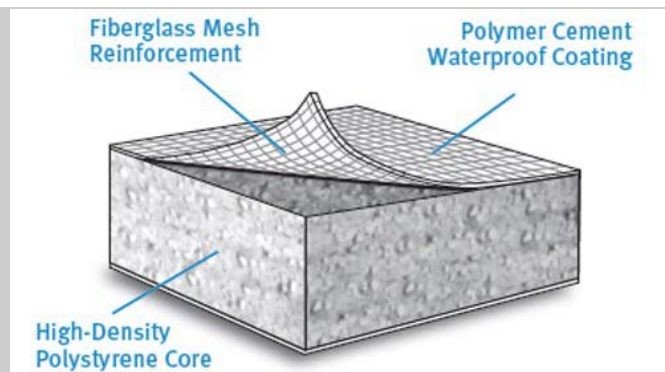

barriers on framing members for shower applications.

A vapor barrier is still recommended for steam room and steam shower installations. A minimum of 6 mil polyethylene or equivalent membrane may be used behind ProPanel™ Backer or a liquid applied waterproof membrane may be applied over ProPanel™ Backer to create a vapor barrier.

ProPanel™ Backer is available in a 1/2" x 3' x 5' panel and provides easier installations without sacrificing performance. Its advantages are its lightweight nature, just under 6 pounds per panel, and its ease of cutting with only a simple utility knife. Attaching the boards is easily accomplished by screwing or nailing through the board with ProPanel™ Backer Tab Washers or ProPanel™ Backer Cap Nails every 8" o.c./25 per board.

For complete waterproof performance, Fin Pan specifies an approved polyurethane sealant in and over all joints and fasteners.

ProPanel™ Backer can be installed in a fraction of the time required for traditional backer boards and without all the mess and weight.

Note: It is the user's responsibility to ensure waterproofness prior to tiling.

#### Technical Information

##### Limitations

ProPanel™ Backer is waterproof, but to ensure a waterproof installation all joints and fasteners must be sealed with a FinPan approved polyurethane sealant.

ProPanel™ Backer is intended for wall, bathtub surround, and countertop applications only.

ProPanel™ Backer panels are not to be used as structural load-bearing members.

\*ProPanel™ Backer may be used on countertops, but should not be used in areas where extremely hot items will be placed directly on the tile. We recommend ProTEC Concrete Backer Board for high heat areas.

ProPanel™ Backer may be used for steam rooms and steam showers however a vapor barrier is highly recommended. Visquene may be used behind ProPanel™ Backer or a liquid applied waterproof membrane may be applied over ProPanel™ Backer to create a vapor barrier.

ProPanel® is a new generation of backer board that offers waterproof performance all in a six-pound board. ProPanel® consists of high-density expanded polystyrene reinforced on both sides with fiberglass mesh and a polymer cement coating.

##### Features:

Lightweight  
Waterproof

Easy to lift and carry  
Easy to cut and install

Available in 1/4" and 1/2" x 3'x5' boards

## BATHTUB WALLS

Wood or Metal Studs

EZ Backer™ Foam Based Backer Board B425-05

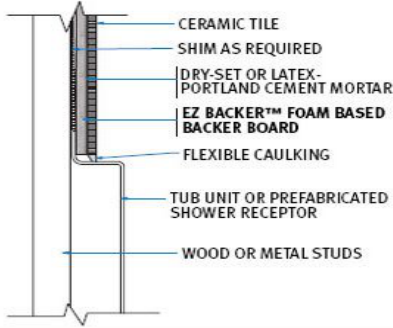

### Materials Needed

- EZ Backer™ Board
- 2" glass fiber mesh tape
- Dry-set mortar, ANSI A118.1
- Grout, ANSI A118.6 (specify type)
- Latex-portland Cement mortar, ANSI A118.4

## SHOWER RECEPTOR

Wood or Metal Studs

EZ Backer™ Foam Based Backer Board B426-05

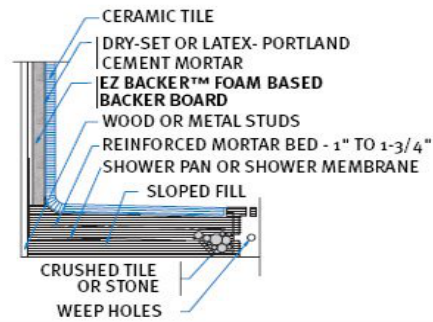

### Materials Needed

- EZ Backer™ Board
- 2" glass fiber mesh tape
- Dry-set mortar, ANSI A118.1
- Grout, ANSI A118.6 (specify type)
- Latex-portland Cement mortar, ANSI A118.4

## CEILING

EZ Backer™ Foam Based Backer Board C315-05

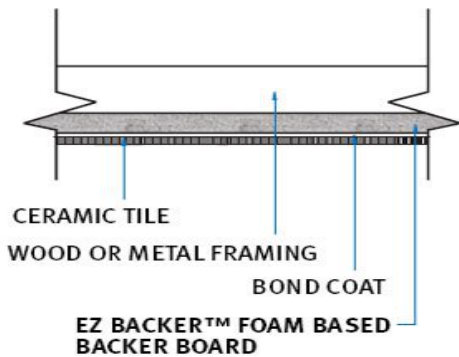

### Materials Needed

- EZ Backer™ Board
- 2" glass fiber mesh tape
- Dry-set mortar, ANSI A118.1
- Grout, ANSI A118.6 (specify type)
- Latex-portland Cement mortar, ANSI A118.4

## WALLS, INTERIOR

Dry-Set Mortar or Latex-Portland Cement Mortar  
EZ Backer™ Foam Based Backer Board W246-05

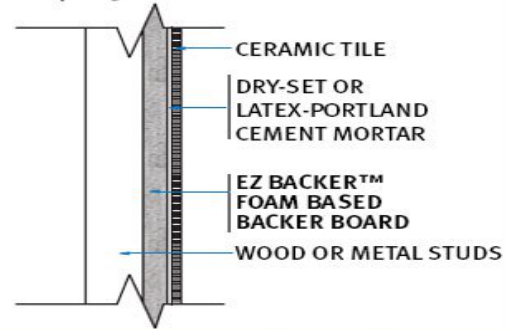

### Materials Needed

- EZ Backer™ Board
- 2" glass fiber mesh tape
- Dry-set mortar, ANSI A118.1
- Grout, ANSI A118.6 (specify type)
- Latex-portland Cement mortar, ANSI A118.4

Approved fasteners include:



Performance Properties

ProPanel™ Backer, when tested by independent laboratories, using standard ASTM test methods, has the following performance

Performance Property	properties:	Test Method	Value
Hydrostatic Water Pressure Test		ASTM D-4068*	Pass
Resistance to Fungi		ASTM G-21	< 10%
Resistance to Bacteria		ASTM G-22	No Growth
<b>Fastener Head Pull Through:</b>		ASTM D-1037	
Screw, Soaked			110 lbs.
Screw, Dry			138 lbs.
Nail, Soaked			93 lbs.

Nail, Dry		<b>118 lbs.</b>
<b>Flexural Strength</b>	<b>ASTM C-203</b>	<b>416 psi.</b>
<b>Tensile Strength</b>	<b>ASTM D-1623</b>	<b>50 psi.</b>
<b>Compressive Strength</b>	<b>ASTM D-1621</b>	<b>31 psi.</b>

**\* Test was conducted in accordance with ANSI A-118.10 Section 4.5-Waterproofness**

### 35 Year Limited Warranty

FinPan, Inc. warrants that this product meets or exceeds applicable manufacturing standards in force at the time of manufacture. Fin Pan will, at its option, repair or replace any product which proves defective due to manufacturing.

This warranty shall apply only if the product is used strictly according to applicable specifications, and/or instructions provided by Fin Pan for its use.

This warranty does not cover damage due to failure of structural elements of the building to which ProPanel™ Backer is attached, structural movement of the building or improper maintenance of the building facility. This warranty does not cover acts of God. Fin Pan shall not be liable otherwise.

Replacement of any defective product or, at Fin Pan's option, refund of the purchase price of any defective product shall be the buyer's sole remedy under this warranty. Fin Pan shall in no event, be held liable for any consequential, incidental or special damages. This warranty constitutes the sole warranty given by Fin Pan, Inc. in connection with this product. Fin Pan, Inc. has authorized no person or company to make or give any other warranties or representations on its behalf.

In particular, there are no implied warranties including, without exception, warranties or merchantability or fitness for a particular purpose. This warranty shall only be valid if the product is stored or maintained according to Fin Pan's specifications. No modification of this warranty in favor of any buyer shall be valid unless given in writing and signed by an authorized representative of Fin Pan, Inc. This warranty gives you specific legal rights and you may also have other rights which vary from state to state.

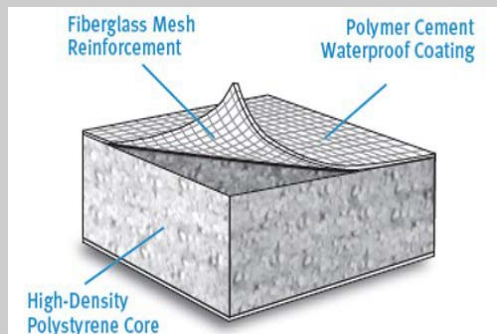

### ProPanel™ Backer FEATURES

- Moisture and mold resistant panel
- Lightweight – less than 6 lbs per panel
- Easy to score, cut and install
- No mess installations – cut indoors
- Added insulation value to wall
- Will not rot or deteriorate